

"MID/ASSIGNMENT"

SUBMITTED BY : MUDASIR

SUBMITTED TO : Engr. Zeshan AHAD

ID - NO : 7755

SUBJECT : Project Management

SECTION : "B"

DEPARTMENT : Be (c)

PART # 01

"Activity List"

- 1) layout drawings
- 2) foundation
- 3) External Construction
- 4) Internal Construction

WALLS

Floorings

Ceilings

Window & doors

Stairs

5) Roof

6) Services

Kitchen

plumbing

Bathroom

Heating/AC

Electrical

Lighting

7) Yard & Access

"WORK BREAKDOWN Structure HOUSE Construction"

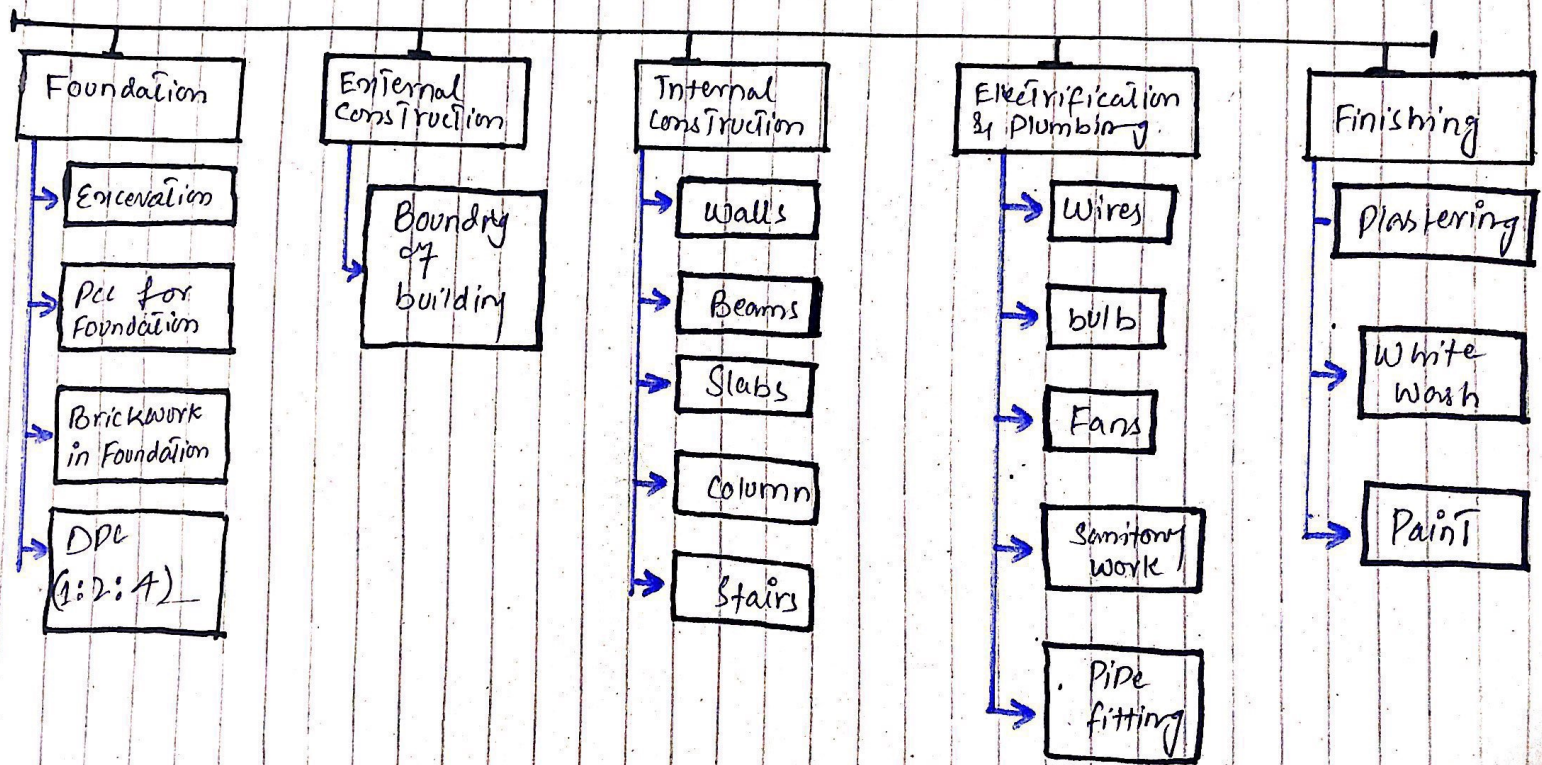

" TIME LINE "

Notation	Activity name	Predecessor	Duration Days
A	LAYOUT & drawing	—	7
B	Excavation	A	4
C	P.C.C for foundation	B	2
D	DPC	C	1
E	Columns	D	4
F	Beams	E	4
G	Stairs	F	6
H	Concreting of Slab	G	2
I	Curing of Slab	H	14
J	Brickwork	I	14
K	Dumbring	J	5
L	electrification	J	8
M	plastering	J, K, L	20
N	Door & window	M	12
O	Flooring & tile work	N	20

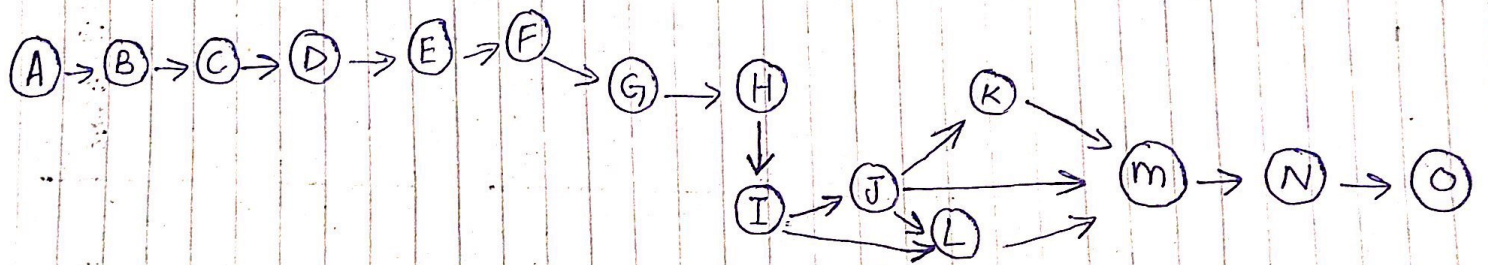

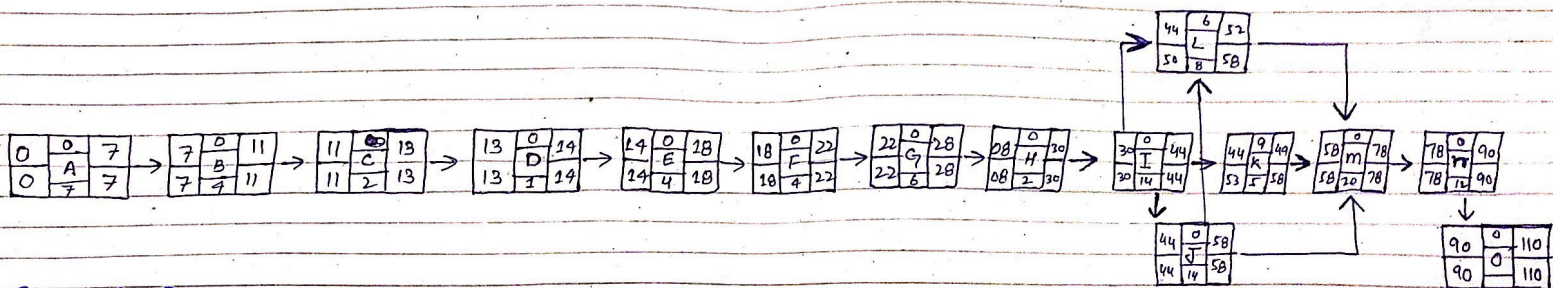

Critical Path

A → B → C → D → E → F → G → H → I → J → K → L → M → N → O

D) Maximum time taken by project is 110 days.

E) Activity K and L has slack time of 9 & 6 days.