

CONSTRUCTION MANAGEMENT



Submitted by

KASHIF YAQUB

ID: 7733

Section B

Submitted to

Dr. Engr. Muhammad Zeeshan Ahad

IQRA NATIONAL UNIVERSITY

PESHAWAR

Part 1

List of Activities

- 1 Survey
- 2 Layout
- 3 Excavation
- 4 Lean concrete (1:4:8)
- 5 Column footing
- 6 Column Reinforcement
- 7 Column formwork
- 8 Concrete for column
- 9 Brick work upto ground level
- 10 Plastering
- 11 Electrification work
- 12 Sanitary & plumbing
- 13 Reinforcement for plinth beam
- 14 Form work for plinth
- 15 Concrete work for plinth beam
- 16 Basement slab form work
- 17 Basement slab form work
- 18 Basement slab & beam concreting

- 19 Extension of column Reinforcement
- 20 Brickwork upto first floor level
- 21 Formwork for columns of ground story
- 22 Concrete work for columns of ground story
- 23 Formwork for beam & slab of ground floor
- 24 Reinforcement for beam and slab of ground floor
- 25 Concrete work for beam and slab of ground floor
- 26 Extension of columns reinforcement ^{for 1st floor}
- 27 Brickwork of first floor
- 28 Form work for column of first floor
- 29 Concrete work for column of first floor
- 30 Formwork for beam and slab of first floor
- 31 Reinforcement for beam and slab of first floor
- 32 Concreting for beam & slab of first floor
- 33 Tile work
- 34 Over head tank
- 35 White wash & colour wash
- 36 Window frames & door frames
- 37 Stair case basement
- 38 Ground floor stair case
- 39 First floor stair case

Work Breakdown Structure Construction Of House

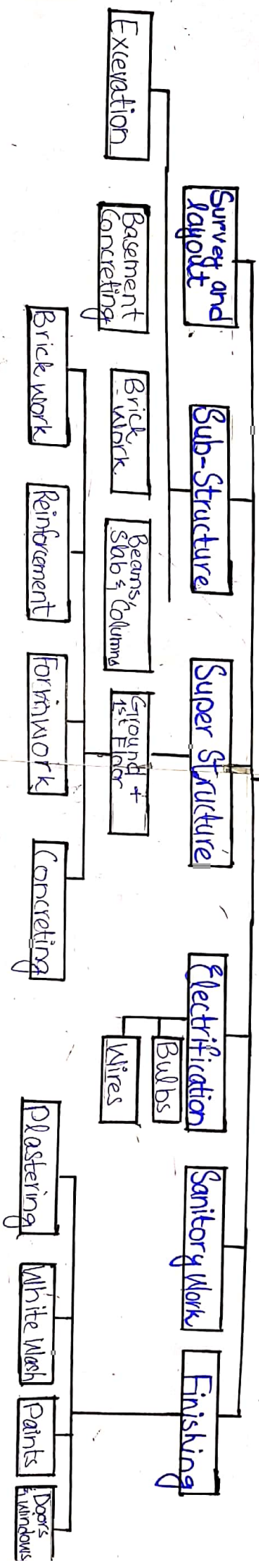

Symbol	Activity Name	Predecessor	Duration (Days)	Slack Time
A	Survey	-	1	0
B	Layout	A	1	0
C	Excavation	B	1	0
D	Lean Concrete (1:4:8)	C	1	0
E	Column Footing	C	1	2
F	Column Reinforcement	E	1	2
G	Column Formwork	F	1	2
H	Concreting For Column	G	1	2
I	Brickwork upto ground level	D	15 th	0
J	Plastering	I	5	7
K	Electrification Work	I	5	12

L	Sanitary & plumbing	I, D	10	17
M	Reinforcement for plinth beam	I, H	1	24
N	Formwork for plinth beam	M	1	24
O	Concreting for plinth beam	N	1	24
P	Basement slab formwork	I, H	1	0
Q	Basement beam formwork	P	1	0
R	Concreting of basement beams & slab	Q	1	0
S	extension of column Reinforcement upto 1 st floor	R	1	23
T	Brickwork upto first floor level	R	5	0
U	Formwork for columns of ground story	R	1	3
V	Concreting for columns of ground story	U	1	3

W	Formwork for slab of ground floor	U/T	1	0
X	Reinforcement for basement slab of ground floor	W	2	0
Y	Concreting for beam & slab of ground floor	X	1	0
Z	Extension of columns	Y	1	14
A ₁	Brickwork of first floor	Y	5	0
B ₂	Formwork for column of first floor	Y	1	5
C ₃	Concreting for columns of first floor	B ₂	1	5
D ₄	Formwork for beam & slab of first floor	C ₃ , A ₄	1	2
E ₅	Reinforcement for beam and slab of first floor	D ₄	1	2

F6	Concreting for beam & slab of first floor	E5	1	2
G7	Floor plastering & Tile Work	D, P, X	10	5
H8	Over head tank	Y	6	14
I9	White wash & colour wash	J	15	7
J10	Window frames and Doors frames	I, T, A1	10	0
K11	Stair Case basement	R	5	23
L12	Stair Case ground floor	Y	5	10
M13	Stair Case first floor	F6	5	2

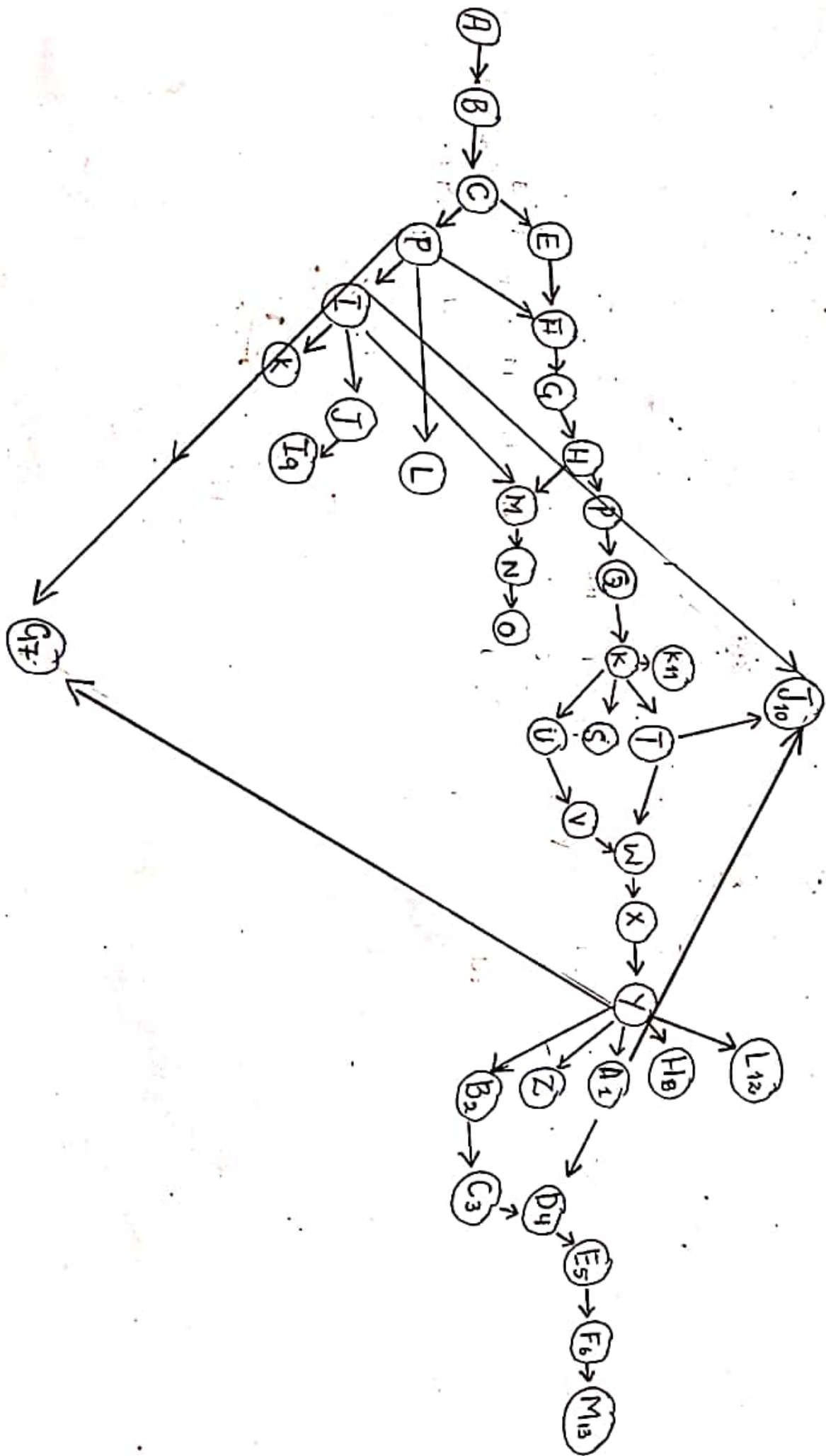

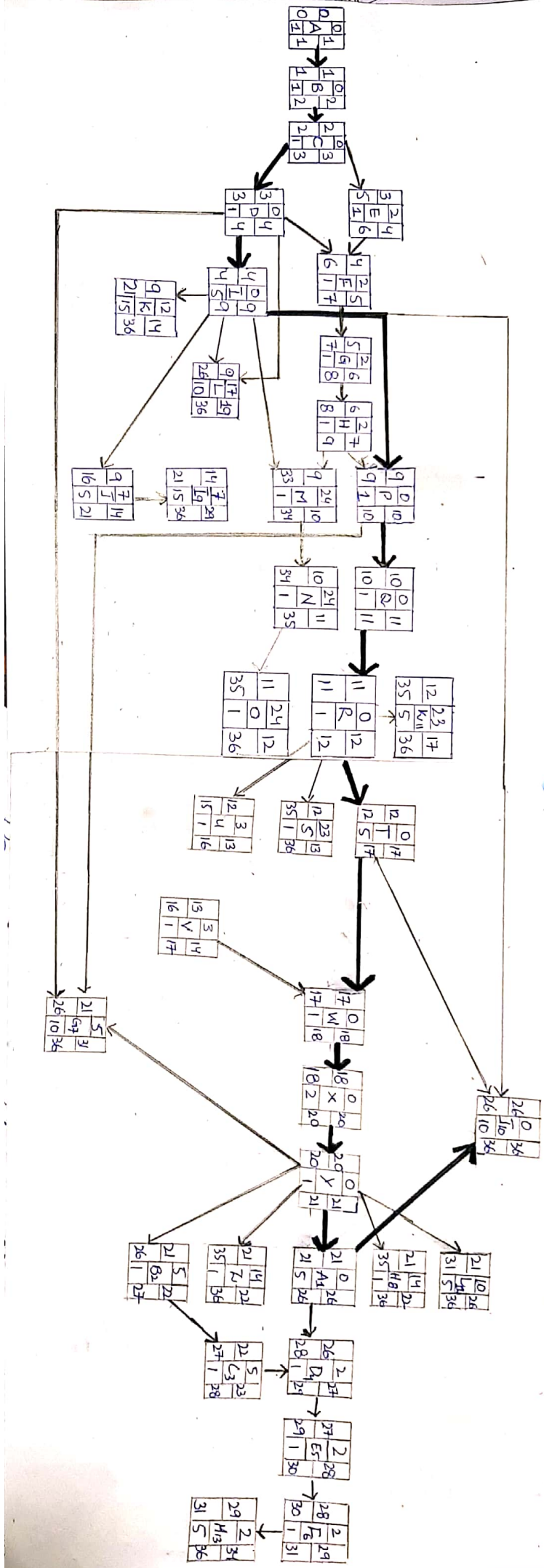

Paths

1) $A, B, C, D, I, P, Q, R, T, W, X, Y, A_{10}, J_{10}$
 $1+1+1+1+5+1+1+1+5+1+2+1+5+10$

Duration = 36 days

2) $A, B, C, D, I, P, Q, R, T, J_{10}$
 $1+1+1+1+5+1+1+1+5+10$

Duration = 27 days

3) A, B, C, D, I, J_{10}
 $1+1+1+1+5+10$

Duration = 19 days

Hence path 1 is critical path and maximum time taken by project is 36 days

(Slack time for each activity is given in timeline)